

Shield Extreme-X2 for iPad 10

w/3.5 mm Adapter and
Tamper-Resistant Design

1

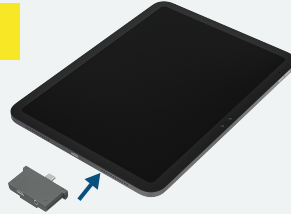

Plug the included 3.5mm/USB-C module into the USB-C port on the iPad device.

2



Next, carefully insert the device into the back half of the case, making sure that the plugged in module is lined up with the opening on the bottom of the case.

3

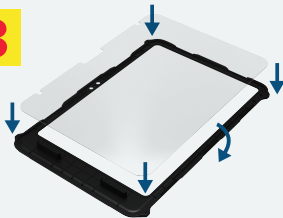

Carefully peel off the protective film from the screen protector, then position the screen protector within the underside of the plastic front frame

4

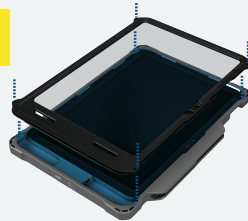

Attach and snap the front plastic frame onto the back half of the case, making sure that the soft TPU covers the outer edges of the frame.

5

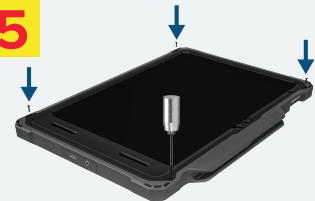

Using the included allen wrench, insert each of the 4 hex screws into each of the 4 corners. Fasten until snug; do not over tighten.